

# Protocols for TB-Gold Testing

## QuantIFERON®-TB Gold Plus (QFT®-Plus)

Aculabs - Ancillary Service Provider to the Mid-Atlantic



### TB-GOLD TESTING FOR TUBERCULOSIS

Each tube part of the TB Gold Plus kit features a black mark near the bottom of the tube (as shown in Figure 1 to the right). This thick black line marks the range the tubes should be filled.

*Overfilling or underfilling tubes should be avoided.*

#### 1. COLLECTION OF BLOOD INTO EACH TUBE

Each test collection kit comes with a total of four tubes. A phlebotomist or nurse performing venipuncture on a patient must collect 0.8-1.2 mL of blood directly into each of the 4 QuantIFERON®-TB Gold Plus tubes.

Once collected, tubes should be stored at room temperature (temperatures ranging from 63°F to 77°F).

#### 2. SOLUBILIZE THE ANTIGEN THROUGH SHAKING

Once all four tubes have been filled with the appropriate amount of blood, the person performing the collection must now shake all four tubes. Shaking the tubes is done to ensure that the entire surface of the tube is coated with blood to solubilize the antigen on the tube walls.

Hold all four tubes firmly in your hand. Move your hand in an up and down motion, holding the tubes upright. Shake the tubes firmly but not aggressively 10 times (see Figure 2 to the right).

#### 3. SPECIMEN TRANSPORT & TEST REQUISITION

Nurses should tape their test requisition forms to their unopened kits and leave both in their lab book for phlebotomist to see under the appropriate date.

Once the blood is collected, the person collecting should place all tubes into the “QFT-Plus Kit” box and seal the top of the box by removing tape from the adhesive. The fully sealed kit and requisition form must be placed all together into specimen bag and make its way back to Aculabs.

Nurses must make sure a requisition print-out is in their lab book at time of collection. Our phlebotomists do not draw from patients without a test requisition form present.

**FIGURE 1:**

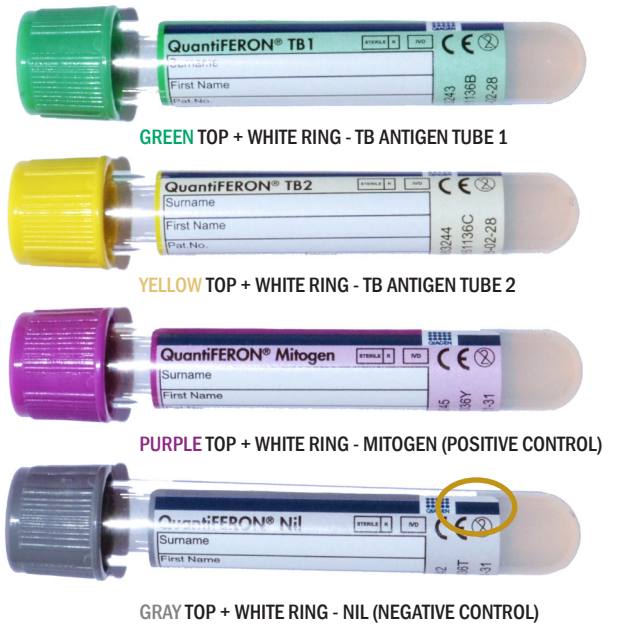

**FIGURE 2:**

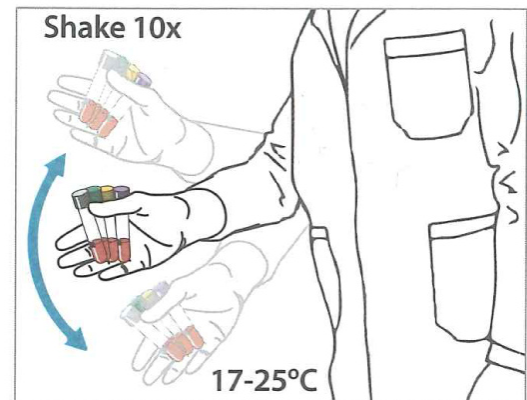

Nurses who perform draws should call their CSR to confirm. Blood should be drawn from 5AM to 10AM and arrive to Aculabs no later than 7PM to 10PM for incubation.

For **employee testing**, use your facility employee account to avoid any results transmitted to unit. Ask your CSR for employee log-in details.